

FLORIDA INTERNATIONAL UNIVERSITY BT-925 CASACUBA MODESTO A. MAIDIQUE CAMPUS



04/22/2024

OWNER

FLORIDA INTERNATIONAL UNIVERSITY
MODESTO MAIDIQUE CAMPUS
MIAMI, FL 33199

ARCHITECT

HKS ARCHITECTS, INC.
2020 SALZEDO ST., 4TH FLOOR
CORAL GABLES, FL 33134

MEP ENGINEER

SGM ENGINEERING
5805 BLUE LAGOON DRIVE, STE 285
MIAMI, FL 33126

STRUCTURAL ENGINEER

BLISS & NYTRAY, INC.
5835 WATERFORD DISTRICT DRIVE, SUITE 400
MIAMI, FL 33126

CIVIL ENGINEER

MILLER-LEGG & ASSOCIATES, INC.
13800 NW 5TH STREET
SUNRISE, FL 33325

LANDSCAPE ARCHITECT

EDSA, INC.
1512 E. BROWARD BOULEVARD, SUITE 110
FT. LAUDERDALE, FL 33301



ADVANCED SCHEMATIC DESIGN

Drawing name: G:\Teams\SECAR\SEC230113_FU_Casacuba\EDS\Sub06-SHEETS\30x42 ADV SCHEMATIC\L3-1-01-HARDSCAPE PLAN.dwg L3-1-01-HARDSCAPE PLAN Apr 17, 2024 4:30pm by wcdang

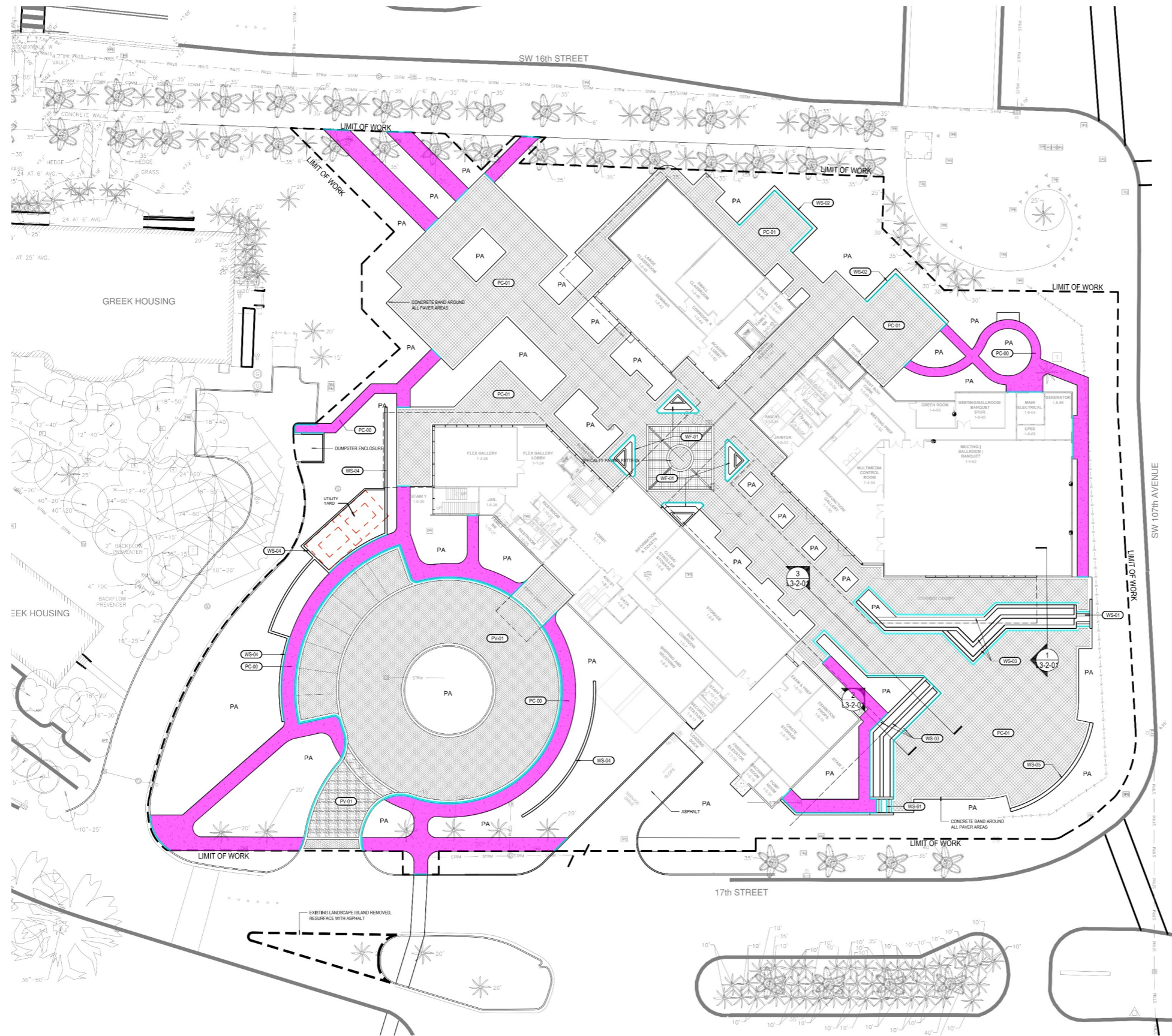

PC00 - Concrete Sidewalk
Expansion Joint - 1/2" Polyurethane Joint Sealant

1780.3 SQ FT
911.6 FT

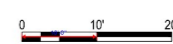

LEGEND		
SYMBOL	DETAIL	DESCRIPTION
PA	N/A	PLANTING AREA
PC-00	1,2,L,3-3-01	CONCRETE WALK
PC-01	3,L,3-3-01	PEDESTRIAN PAVERS
PV-01	4,L,3-3-01	VEHICULAR PAVERS
WS-01	5,L,3-3-01	STAIRS
WS-02	6,L,3-3-01	SEAT WALL WITH LED LIGHTING
WS-03	7,L,3-3-01	CIP RETAINING SEAT WALL WITH LED LIGHTING
WS-04	8,L,3-3-01	CMU DECORATIVE SCREEN WALL
WS-05	1,L,3-4-01	DECORATIVE PROJECTION WALL
WF-01		WATER FEATURE

HKS

ARCHITECT
HKS ARCHITECTS, INC.
2020 SALZEDO STREET, 4TH FLOOR
CORAL GABLES, FL 33134

MEP ENGINEER
SGM ENGINEERING
5805 BLUE LAGOON DRIVE, STE 205
MIAMI, FL 33126

STRUCTURAL ENGINEER
BLISS & NYSTRAY, INC.
5835 WATERFORD DISTRICT DRIVE, SUITE 400
MIAMI, FL 33126

CIVIL ENGINEER
MILLER LEGG & ASSOCIATES, INC.
13880 NW 5TH STREET
SUNRISE, FL 33325

LANDSCAPE ARCHITECT
EDSA, INC.
1512 E. BROWARD BOULEVARD, SUITE 110
FT. LAUDERDALE, FL 33301

edsa

04/22/2024

CASACUBA
BT-925

PROJECT ADDRESS: Moderna Molecular Campus
Miami, FL 33199

SEAL & SIGNATURE

TO THE BEST OF MY KNOWLEDGE THESE DRAWINGS AND SPECIFICATIONS COMPLY WITH THE APPLICABLE MINIMUM BUILDING CODES AND THE APPLICABLE FIRE SAFETY STANDARDS AS DETERMINED BY THE LOCAL AUTHORITY IN ACCORDANCE WITH FIRE SECTION 115 AND CHAPTER 633 OF THE FLORIDA STATUTES.

TERESA SWIFT CAMPBELL, STATE OF FLORIDA, PROFESSIONAL ARCHITECT, LICENSE NO. 394
THIS ITEM HAS BEEN ELECTRONICALLY SIGNED AND SEALED BY: TERESA SWIFT CAMPBELL, OR 01150033, USING A DIGITAL SIGNATURE
PRINTED COPIES OF THIS DOCUMENT ARE NOT CONSIDERED SIGNED AND SEALED AND THE SIGNATURE MUST BE VERIFIED ON ANY ELECTRONIC COPIES

HKS ARCHITECTS, INC. QUALIFYING AGENT
ARCHITECT'S EXCELLENCE AWARD

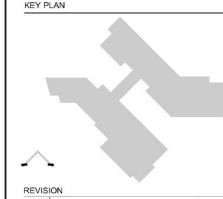

HKS PROJECT NUMBER
25991.000









DATE
04/19/24









ISSUE
ADVANCED SCHEMATIC DESIGN

SHEET TITLE
HARDSCAPE PLAN

SHEET NO.
L3-1-01

TITLE BLOCK VERSION: 20210320
 MODEL: AutoCAD 2024
 TEMPLATE VERSION: 2312.4
 PRINT DATE: 4/19/2024 5:01:58 PM
 PROJECT ADDRESS: Moderna Building Campus Miami, FL 33199

-  Sealant
-  Storefront Sealant
-  Fire Rated Sealant
-  Bentonite Waterproofing
-  Bentonite Waterproofing
-  Bathroom Waterproofing @ Walls
-  Jan. Waterproofing @ Walls
-  Bathroom Waterproofing @ base
-  Jan Waterproofing @ base

- 2515.0 FT 
- 260.4 FT 
- 148.9 FT 
- 396.2 SQ FT 
- 515.3 SQ FT 
- 1532.7 SQ FT 
- 343.4 SQ FT 
- 529.2 SQ FT 
- 118.6 SQ FT 

GENERAL NOTES - FLOOR PLAN

1. REFER TO SHEET A3.00 FOR PARTITION TYPES, GRAPHIC AND SYMBOLIC DESIGNATIONS, NOTES, AND DETAILS.
2. ALL DOORS ARE LOCATED 4'-0" AWAY FROM ADJACENT WALL TO INSIDE FRAME, U.N.O.
3. REFER TO SHEET A9.00 - A9.02 FOR FINISH INFORMATION AND SCHEDULES.
4. REFER TO SHEET A5.11 - A5.12 FOR EXTERIOR ELEVATIONS AND DETAILS.
5. REFER TO SHEET A8.11 - A8.21 FOR STAIR AND ELEVATOR SECTIONS AND DETAILS.
6. FULL HEIGHT WALLS WITH SOUND ATTENUATION SHALL BE PROVIDED AT ALL GALLERIES, CLASSROOMS, RESTROOMS, OFFICES, CONFERENCE ROOMS, AND EVENT SPACES INCLUDING BACK OF HOUSE EVENT SPACES.
7. ALL DOORS TO BE 7'-0" IN HEIGHT. DOOR RATINGS SHALL CORRESPOND TO WALL RATINGS IN WHICH THEY ARE PLACED.
8. ALL DATA ROOMS TO RECEIVE 2 HOUR FIRE RATING.
9. ALL EXTERIOR DIMENSIONS ARE FROM FACE OF EXTERIOR FINISH, U.N.O.

ROOM NAME LEGEND

LEVEL	CLASSIFICATION	ROOM NUMBER
1 LEVEL 01	1 LOBBY	1 ROOM
2 LEVEL 02	2 CLASSROOM	
	3 GALLERY	
	4 EVENT SPACE	
	5 CORRIDOR	
	6 OFFICE	
	7 ELEVATOR	
	8 STORAGE / MEP	
	9 STAIR	
	10 CORE / SHELL	

HKS

ARCHITECT
 HKS ARCHITECTS, INC.
 2020 SALZEDO STREET, 4TH FLOOR
 CORAL GABLES, FL 33134

MEP ENGINEER
 SOM ENGINEERING
 5855 BLUE LAGOON DRIVE, STE 205
 MIAMI, FL 33128

STRUCTURAL ENGINEER
 BLES & WYTRAT, INC.
 5835 WATERFORD DISTRICT DRIVE, SUITE 400
 MIAMI, FL 33128

CIVIL ENGINEER
 MILLER LEGG & ASSOCIATES, INC.
 13880 NW 5TH STREET
 SUNRISE, FL 33325

LANDSCAPE ARCHITECT
 EDGA, INC.
 1512 E. BROWARD BOULEVARD, SUITE 110
 FT. LAUDERDALE, FL 33301

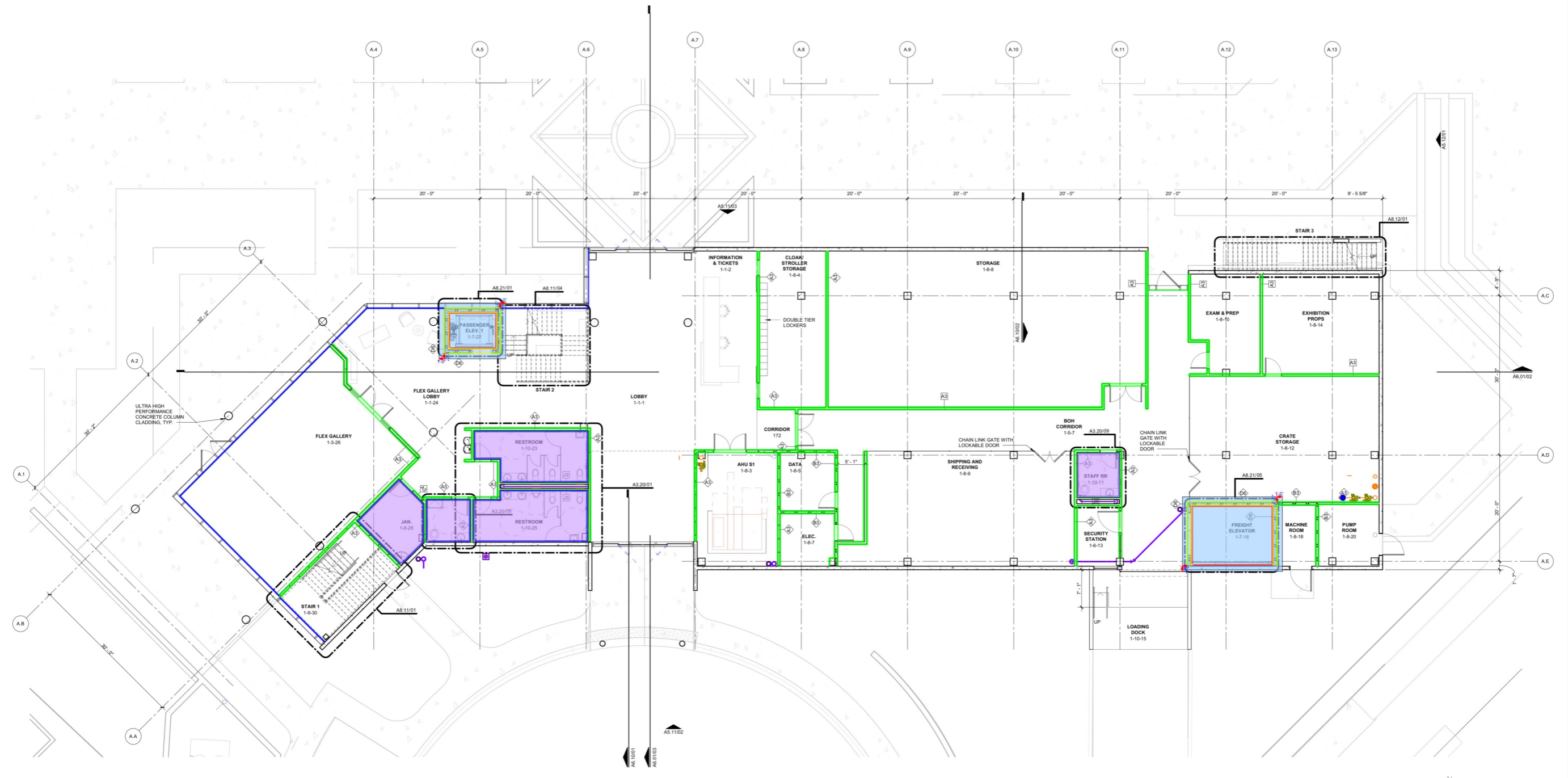

 04/22/2024

CASACUBA
BT-925
 PROJECT ADDRESS: Moderna Building Campus Miami, FL 33199

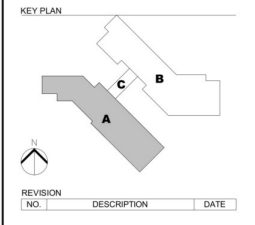

SEAL & SIGNATURE

INTERIM REVIEW ONLY
 These documents are incomplete, and are intended for interim review only and are not intended for regulatory approval, permit, or construction purposes.
 Architect: NATHAN BUTLER
 Arch. Reg. No.: AR0516491
 Date: 04/19/2024





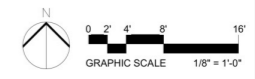





01 FLOOR PLAN - ENLARGED - AREA A - LEVEL 01
 1/8" = 1'-0"



HKS PROJECT NUMBER
25991.000
 DATE
04/19/2024
 ISSUE
ADVANCED SCHEMATIC DESIGN
 SHEET TITLE
FLOOR PLAN - ENLARGED - AREA A - LEVEL 01
 SHEET NO.
A2.11

TITLE BLOCK VERSION: 20210320
 MODEL: A:\models\25991\100_Casacuba_2023\A_01_Casacuba_2023.rvt
 PRINT DATE: 4/19/2024 1:00:00 PM
 TEMPLATE VERSION: 23.2.4
 HKS PROJECT NUMBER: 25991.000

-  Sealant
-  Storefront Sealant
-  Fire Rated Sealant
-  Bentonite Waterproofing
-  Bentonite Waterproofing
-  Jan. Waterproofing @ Walls
-  Bathroom Waterproofing @ Walls
-  Bathroom Waterproofing @ base
-  Jan Waterproofing @ base

- 2167.5 FT 
- 483.6 FT 
- 61.8 FT 
- 135.2 SQ FT 
- 199.2 SQ FT 
- 242.8 SQ FT 
- 1151.4 SQ FT 
- 398.5 SQ FT 
- 57.3 SQ FT 

GENERAL NOTES - FLOOR PLAN

1. REFER TO SHEET A3.00 FOR PARTITION TYPES, GRAPHIC AND SYMBOLIC DESIGNATIONS, NOTES, AND DETAILS.
2. ALL DOORS ARE LOCATED 4' AWAY FROM ADJACENT WALL TO INSIDE FRAME, U.N.O.
3. REFER TO SHEET A9.00 - A9.02 FOR FINISH INFORMATION AND SCHEDULES.
4. REFER TO SHEET A5.11 - A5.12 FOR EXTERIOR ELEVATIONS AND DETAILS.
5. REFER TO SHEET A8.11 - A8.21 FOR STAIR AND ELEVATOR SECTIONS AND DETAILS.
6. FULL HEIGHT WALLS WITH SOUND ATTENUATION SHALL BE PROVIDED AT ALL GALLERIES, CLASSROOMS, RESTROOMS, OFFICES, CONFERENCE ROOMS, AND EVENT SPACES INCLUDING BACK OF HOUSE EVENT SPACES.
7. ALL DOORS TO BE 7'-0" IN HEIGHT. DOOR RATINGS SHALL CORRESPOND TO WALL RATINGS IN WHICH THEY ARE PLACED.
8. ALL DATA ROOMS TO RECEIVE 2 HOUR FIRE RATING.
9. ALL EXTERIOR DIMENSIONS ARE FROM FACE OF EXTERIOR FINISH, U.N.O.

ROOM NAME LEGEND

LEVEL	CLASSIFICATION	ROOM NUMBER
1 LEVEL 01	1 LOBBY	1 ROOM
2 LEVEL 02	2 CLASSROOM	
	3 GALLERY	
	4 EVENT SPACE	
	5 CORRIDOR	
	6 OFFICE	
	7 ELEVATOR	
	8 STORAGE / MEP	
	9 STAIR	
	10 CORE / SHELL	

HKS

ARCHITECT
 HKS ARCHITECTS, INC.
 2020 SALZEDO STREET, 4TH FLOOR
 CORAL GABLES, FL 33134

MEP ENGINEER
 SOM ENGINEERING
 5855 BLUE LAGOON DRIVE, STE 205
 MIAMI, FL 33126

STRUCTURAL ENGINEER
 BLES & WYTRAT, INC.
 5835 WATERFORD DISTRICT DRIVE, SUITE 400
 MIAMI, FL 33126

CIVIL ENGINEER
 MILLER LEGG & ASSOCIATES, INC.
 13880 NW 5TH STREET
 SUNRISE, FL 33325

LANDSCAPE ARCHITECT
 EDGA, INC.
 1512 E. BROWARD BOULEVARD, SUITE 110
 FT. LAUDERDALE, FL 33301

 04/22/2024

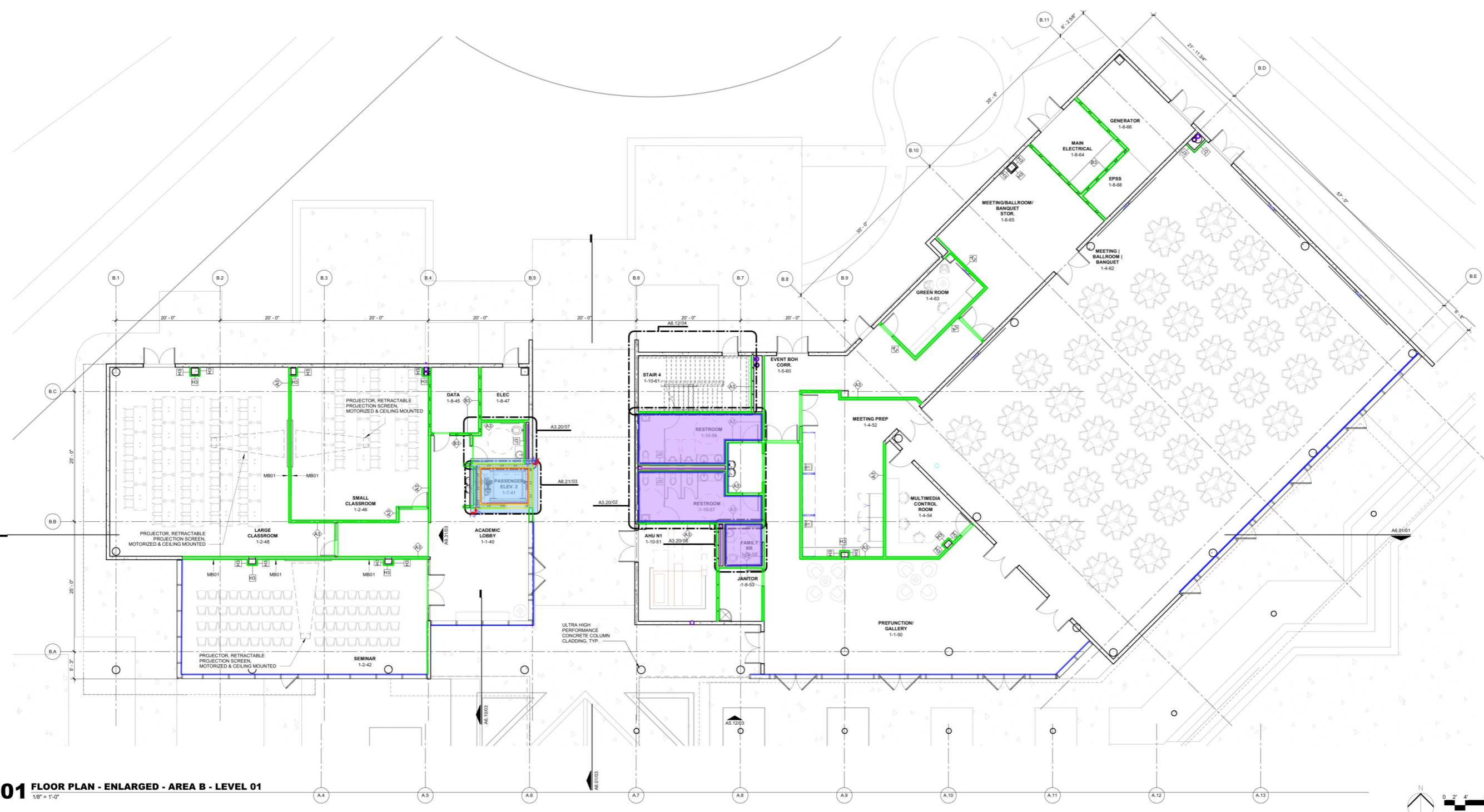

01 FLOOR PLAN - ENLARGED - AREA B - LEVEL 01
 1/8" = 1'-0"

CASACUBA
BT-925
 PROJECT ADDRESS: Moderna Medicine Campus
 Miami, FL 33199

SEAL & SIGNATURE

INTERIM REVIEW ONLY
 These documents are incomplete, and are released for interim review only and are not intended for regulatory approval, permit, or construction purposes.
 Architect: NATHAN BUTLER
 Arch. Reg. No.: AR0516491
 Date: 04/19/2024

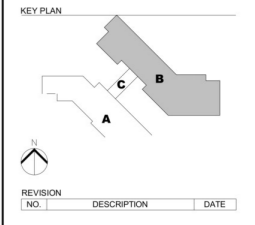

HKS PROJECT NUMBER
25991.000
 DATE
04/19/2024
 ISSUE
ADVANCED SCHEMATIC DESIGN
 SHEET TITLE
FLOOR PLAN - ENLARGED - AREA B - LEVEL 01
 SHEET NO.
A2.12

GRAPHIC SCALE 1/8" = 1'-0"
 © HKS, INC.

TITLE BLOCK VERSION: 20210320
 MODEL: A:\models\25991\000_Casacuba_2023\A_1\000_Casacuba_2023.rvt
 TEMPLATE VERSION: 2312.4
 PRINT DATE: 4/19/2024 4:02 PM

- Sealant
- Storefront Sealant
- Fire Rated Sealant
- Multi-Ply Modified Bitumen Waterproofing
- Bathroom Waterproofing @ base
- Bathroom Waterproofing @ Walls

- 1739.2 FT
- 631.8 FT
- 120.3 FT
- 2720.1 SQ FT
- 321.6 SQ FT
- 916.6 SQ FT

GENERAL NOTES - FLOOR PLAN

1. REFER TO SHEET A3.00 FOR PARTITION TYPES, GRAPHIC AND SYMBOLIC DESIGNATIONS, NOTES, AND DETAILS.
2. ALL DOORS ARE LOCATED 4' AWAY FROM ADJACENT WALL TO INSIDE FRAME, U.N.O.
3. REFER TO SHEET A9.00 - A9.02 FOR FINISH INFORMATION AND SCHEDULES.
4. REFER TO SHEET A5.11 - A5.12 FOR EXTERIOR ELEVATIONS AND DETAILS.
5. REFER TO SHEET A8.11 - A8.21 FOR STAIR AND ELEVATOR SECTIONS AND DETAILS.
6. FULL HEIGHT WALLS WITH SOUND ATTENUATION SHALL BE PROVIDED AT ALL GALLERIES, CLASSROOMS, RESTROOMS, OFFICES, CONFERENCE ROOMS, AND EVENT SPACES INCLUDING BACK OF HOUSE EVENT SPACES.
7. ALL DOORS TO BE 7'-0" IN HEIGHT. DOOR RATINGS SHALL CORRESPOND TO WALL RATINGS IN WHICH THEY ARE PLACED.
8. ALL DATA ROOMS TO RECEIVE 2 HOUR FIRE RATING.
9. ALL EXTERIOR DIMENSIONS ARE FROM FACE OF EXTERIOR FINISH, U.N.O.

ROOM NAME LEGEND

LEVEL	CLASSIFICATION	ROOM NUMBER
1 LEVEL 01	1 LOBBY	1 ROOM
2 LEVEL 02	2 CLASSROOM	
	3 GALLERY	
	4 EVENT SPACE	
	5 CORRIDOR	
	6 OFFICE	
	7 ELEVATOR	
	8 STORAGE / MEP	
	9 STAIR	
	10 CORE / SHELL	

HKS

ARCHITECT
 HKS ARCHITECTS, INC.
 2020 SALZEDO STREET, 4TH FLOOR
 CORAL GABLES, FL 33134

MEP ENGINEER
 SOM ENGINEERING
 5855 BLUE LAGOON DRIVE, STE 205
 MIAMI, FL 33126

STRUCTURAL ENGINEER
 BLES & WYTRAV, INC.
 5835 WATERFORD DISTRICT DRIVE, SUITE 400
 MIAMI, FL 33126

CIVIL ENGINEER
 MILLER LEGG & ASSOCIATES, INC.
 13880 NW 5TH STREET
 SUNRISE, FL 33325

LANDSCAPE ARCHITECT
 EDGA, INC.
 1512 E. BROWARD BOULEVARD, SUITE 110
 FT. LAUDERDALE, FL 33301



CASACUBA
BT-925

PROJECT ADDRESS: Moderna Medicine Campus
 Miami, FL 33199

SEAL & SIGNATURE

INTERIM REVIEW ONLY

These documents are incomplete, and are released for interim review only and are not intended for regulatory approval, permit, or construction purposes.

Architect: NATHAN BUTLER
 Arch. Reg. No.: AR0516491
 Date: 04/19/2024

KEY PLAN

REVISION

NO.	DESCRIPTION	DATE

HKS PROJECT NUMBER
25991.000

DATE
04/19/2024

ISSUE
ADVANCED SCHEMATIC DESIGN

SHEET TITLE
FLOOR PLAN - ENLARGED - AREA A - LEVEL 02



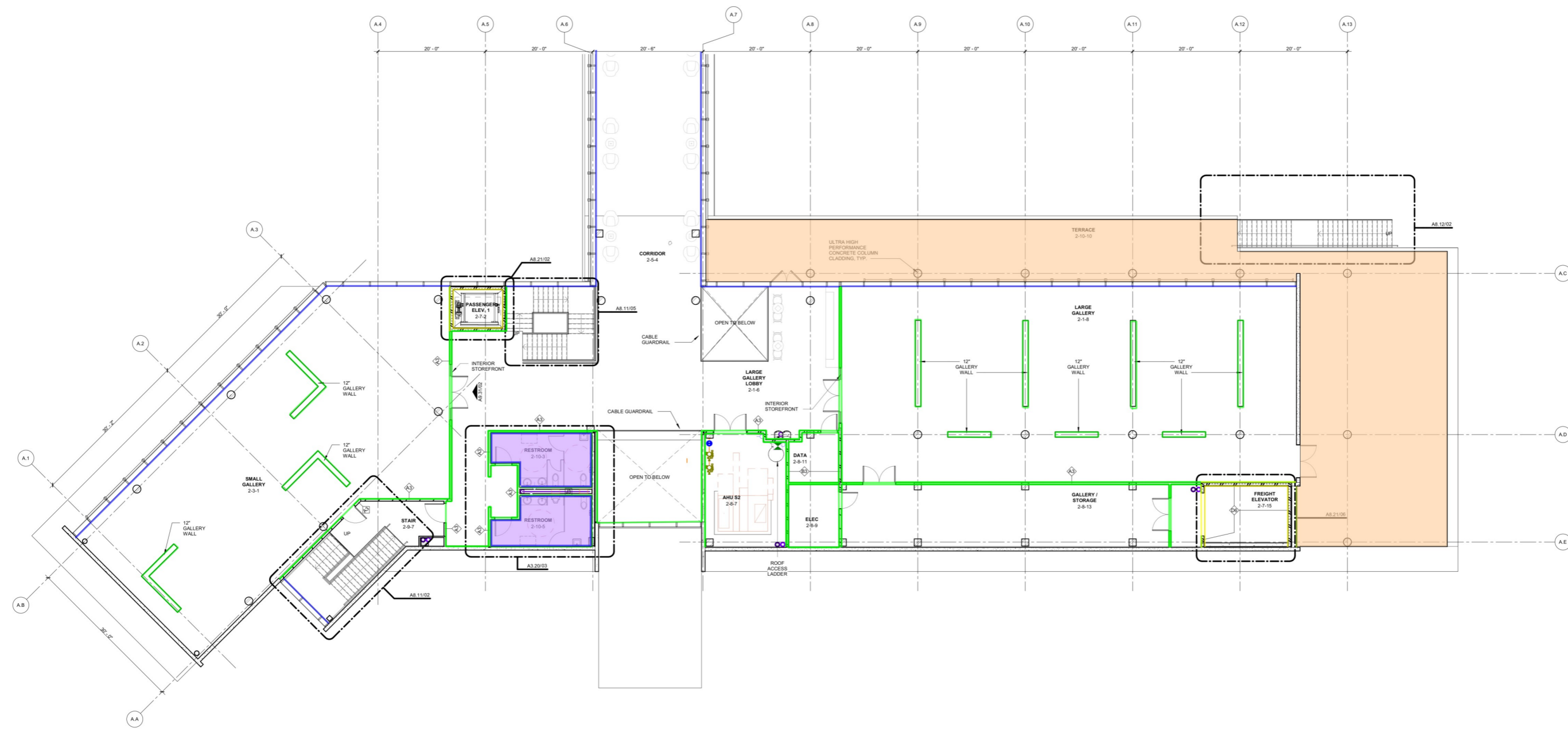

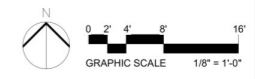

SHEET NO.
A2.21









01 FLOOR PLAN - ENLARGED - AREA A - LEVEL 02
 1/8" = 1'-0"



TITLE BLOCK VERSION: 20210320
 MODEL: A:\models\25991\100_Casacuba_2023\100_Casacuba_2023.rvt
 PRINT DATE: 4/19/2024 10:04 PM
 TEMPLATE VERSION: 231.4

-  Sealant
-  Storefront Sealant
-  Fire Rated Sealant
-  Bathroom Waterproofing @ base
-  Jan Waterproofing @ base
-  Bathroom Waterproofing @ Walls
-  Jan. Waterproofing @ Walls

-  2487.7 FT
-  575.5 FT
-  64.3 FT
-  331.7 SQ FT
-  29.2 SQ FT
-  1041.8 SQ FT
-  173.1 SQ FT

GENERAL NOTES - FLOOR PLAN

1. REFER TO SHEET A3.00 FOR PARTITION TYPES, GRAPHIC AND SYMBOLIC DESIGNATIONS, NOTES, AND DETAILS.
2. ALL DOORS ARE LOCATED 4' AWAY FROM ADJACENT WALL TO INSIDE FRAME, U.N.O.
3. REFER TO SHEET A9.00 - A9.02 FOR FINISH INFORMATION AND SCHEDULES.
4. REFER TO SHEET A5.11 - A5.12 FOR EXTERIOR ELEVATIONS AND DETAILS.
5. REFER TO SHEET A8.11 - A8.21 FOR STAIR AND ELEVATOR SECTIONS AND DETAILS.
6. FULL HEIGHT WALLS WITH SOUND ATTENUATION SHALL BE PROVIDED AT ALL GALLERIES, CLASSROOMS, RESTROOMS, OFFICES, CONFERENCE ROOMS, AND EVENT SPACES INCLUDING BACK OF HOUSE EVENT SPACES.
7. ALL DOORS TO BE 7'0" IN HEIGHT. DOOR RATINGS SHALL CORRESPOND TO WALL RATINGS IN WHICH THEY ARE PLACED.
8. ALL DATA ROOMS TO RECEIVE 2 HOUR FIRE RATING.
9. ALL EXTERIOR DIMENSIONS ARE FROM FACE OF EXTERIOR FINISH, U.N.O.

ROOM NAME LEGEND

LEVEL	CLASSIFICATION	ROOM NUMBER
1 LEVEL 01	1 LOBBY	1 ROOM
2 LEVEL 02	2 CLASSROOM	
	3 GALLERY	
	4 EVENT SPACE	
	5 CORRIDOR	
	6 OFFICE	
	7 ELEVATOR	
	8 STORAGE / MEP	
	9 STAIR	
	10 CORE / SHELL	

HKS

ARCHITECT
 HKS ARCHITECTS, INC.
 2020 SALZEDO STREET, 4TH FLOOR
 CORAL GABLES, FL 33134

MEP ENGINEER
 SOM ENGINEERING
 5855 BLUE LAGOON DRIVE, STE 205
 MIAMI, FL 33126

STRUCTURAL ENGINEER
 BLES & WYTRAT, INC.
 5835 WATERFORD DISTRICT DRIVE, SUITE 400
 MIAMI, FL 33126

CIVIL ENGINEER
 MILLER LEGG & ASSOCIATES, INC.
 13880 NW 5TH STREET
 SUNRISE, FL 33325

LANDSCAPE ARCHITECT
 EDSA, INC.
 1512 E. BROWARD BOULEVARD, SUITE 110
 FT. LAUDERDALE, FL 33301



CASACUBA
BT-925

PROJECT ADDRESS: Moderna Medicine Campus
 Miami, FL 33199

INTERIM REVIEW ONLY

These documents are incomplete, and are intended for interim review only and are not intended for regulatory approval, permit, or construction purposes.

Architect: NATHAN BUTLER
 Arch. Reg. No.: AR0516491
 Date: 04/19/2024

KEY PLAN



REVISION

NO.	DESCRIPTION	DATE

HKS PROJECT NUMBER
25991.000

DATE
04/19/2024

ISSUE
ADVANCED SCHEMATIC DESIGN

SHEET TITLE
FLOOR PLAN - AREA B - LEVEL 02

SHEET NO.
A2.22

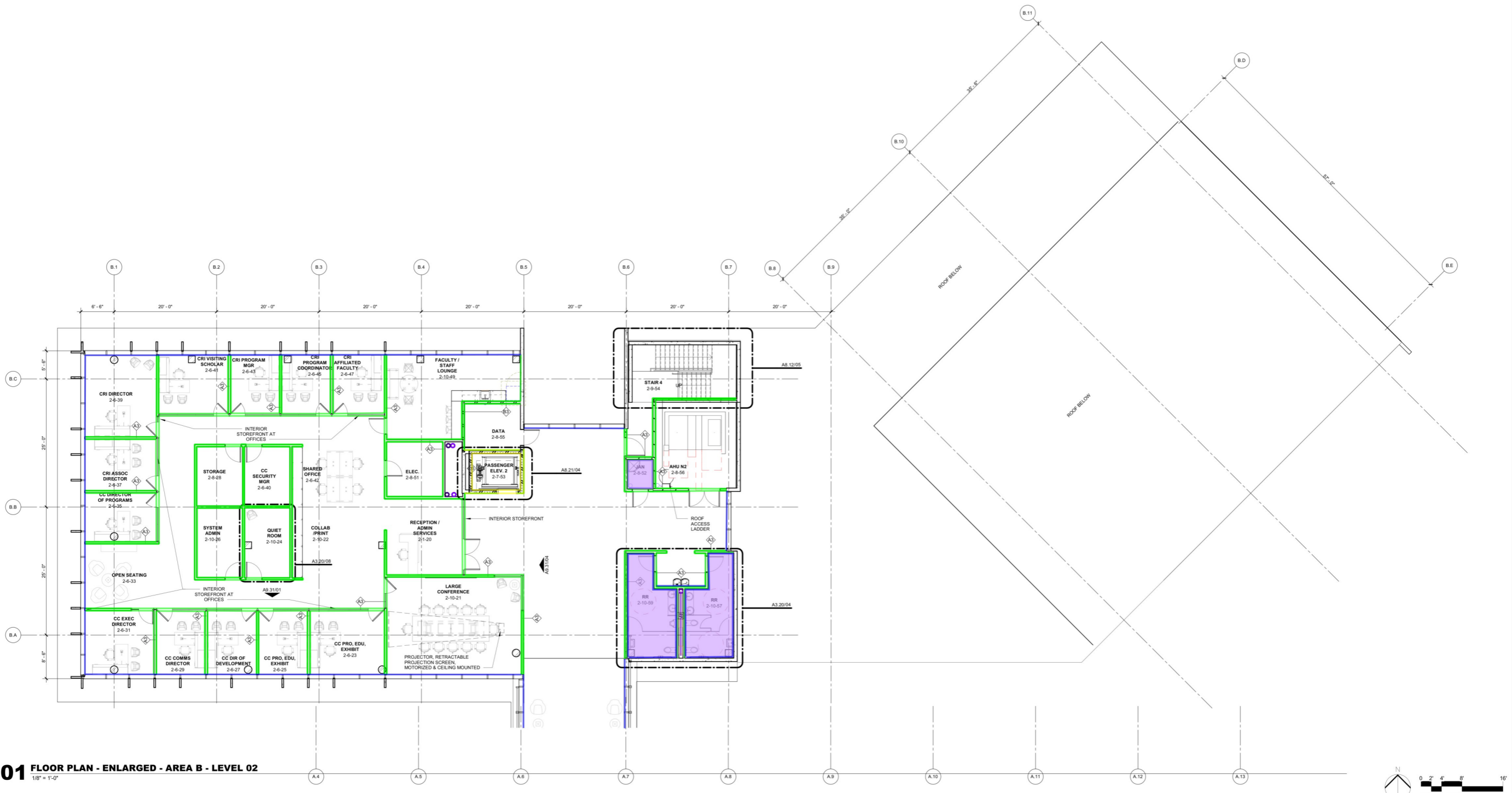

01 FLOOR PLAN - ENLARGED - AREA B - LEVEL 02
 1/8" = 1'-0"

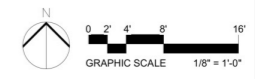

TITLE BLOCK VERSION: 20210320
 MODEL: Autodesk Docs:25991.000_Casacuba_2023A_TU_Casacuba_2021.rvt
 PRINT DATE: 4/19/2024 10:25 PM
 TEMPLATE VERSION: 23.2.4
 HKS PROJECT NUMBER: 25991.000

INTERIOR DESIGN SELECTION SUMMARY					
NAME	MANUFACTURER	MODEL	STYLE	COLOR	COMMENTS
ACOUSTICAL PANEL CEILINGS					
ACT1					SPECIFY GRID SYSTEM COLORS AND TYPES, TRIM PIECES, ETC
ACOUSTICAL TILE CEILINGS					
ACT01			2' X 2'		SPECIFY GRID SYSTEM COLORS AND TYPES, TRIM PIECES, ETC
ACT02			2' X 4'		SPECIFY GRID SYSTEM COLORS AND TYPES, TRIM PIECES, ETC
ACOUSTICAL WALL PANELS					
AWP01					
CARPET					
CP101					
CORNER GUARDS					
CG01					
DECORATIVE PANELS					
DP01		DIGITAL ART WALL PANEL			
DP02		SPECIALTY DECORATIVE PANEL			
ENGINEERED WOOD FLOORING					
WF01					WITH ACOUSTIC UNDER LAYER
FRAMELESS GLAZING SYSTEM					
FG01					
GLASS MARKERBOARDS					
MB01					
INTEGRAL COVE BASE					
ICB01					12" HIGH
INTERIOR PAINT					
IP101					
LARGE FORMAT WALL TILE					
WTL01		LARGE FORMAT WALL TILE			
LUXURY VINYL TILE					
LVT01					
PLASTIC LAMINATE					
PL101					
RUBBER BASE					
RB01					
SEALED CONCRETE					
SC01					
STATIC DISSIPATIVE TILE					
SDT01					
TERRAZZO					
TER01		TERRAZZO FLOORING			
TER02		TERRAZZO WALL			
TILING					
T01		FLOORING TILE			
T02		WALL TILE			
WALL GUARDS					
WG01					
WOOD BASE					
WB01					
WOOD FRAME BUTT-GLAZED SYSTEM					
WFG01					
WOOD WALL PANEL					
WWP01					

INTERIOR FINISH MATERIALS LIST	
ACP	ACOUSTICAL PANEL CEILINGS
ACT	ACOUSTICAL TILE CEILINGS
AWP	ACOUSTICAL WALL PANELS
CD	CORNER GUARDS
CP	CARPET
DP	DECORATIVE PANELS
WF	ENGINEERED WOOD FLOORING
FG	FRAMELESS GLAZING SYSTEM
MB	GLASS MARKERBOARDS
ICB	INTEGRAL COVE BASE
IP	INTERIOR PAINT
LVT	LUXURY VINYL TILE
PL	PLASTIC LAMINATE
RB	RUBBER BASE
SC	SEALED CONCRETE
SDT	STATIC DISSIPATIVE TILE
TER	TERRAZZO
TL	TILING
WG	WALL GUARDS
WB	WOOD BASE
WFG	WOOD FRAME BUTT-GLAZED SYSTEM
WWP	WOOD WALL PANEL

DOOR SCHEDULE						
Mark	Door Material	Frame Type	Width	Hardware		
1-2-42A	WOOD W/ GLASS	WOOD	8'-0"	4' PULL		
1-2-46	WOOD W/ GLASS	WOOD	3'-0"	LEVER		
1-2-48A	WOOD W/ GLASS	WOOD	8'-0"	LEVER		
1-3-26A	FRAMELESS GLASS	WOOD	6'-0"	4' PULL		
1-4-52A	PT WOOD	PT ALUM	8'-0"	LEVER		
1-4-52B	WOOD	WOOD	6'-0"	LEVER		
1-4-54A	WOOD	WOOD	8'-0"	LEVER		
1-4-54B	WOOD	WOOD	3'-0"	4' PULL		
1-4-55A	WOOD	WOOD	6'-0"	4' PULL		
1-4-55B	WOOD	WOOD	6'-0"	4' PULL		
1-4-56A	WOOD	WOOD	6'-0"	LEVER		
1-4-56B	WOOD	WOOD	6'-0"	LEVER		
1-4-56C	WOOD	WOOD	6'-0"	LEVER		
1-4-56D	WOOD	WOOD	6'-0"	LEVER		
1-4-56E	WOOD	WOOD	6'-0"	LEVER		
1-4-56F	WOOD	WOOD	6'-0"	LEVER		
1-4-56G	WOOD	WOOD	6'-0"	LEVER		
1-4-56H	WOOD	WOOD	6'-0"	LEVER		
1-4-56I	WOOD	WOOD	6'-0"	LEVER		
1-4-56J	WOOD	WOOD	6'-0"	LEVER		
1-4-56K	WOOD	WOOD	6'-0"	LEVER		
1-4-56L	WOOD	WOOD	6'-0"	LEVER		
1-4-56M	WOOD	WOOD	6'-0"	LEVER		
1-4-56N	WOOD	WOOD	6'-0"	LEVER		
1-4-56O	WOOD	WOOD	6'-0"	LEVER		
1-4-56P	WOOD	WOOD	6'-0"	LEVER		
1-4-56Q	WOOD	WOOD	6'-0"	LEVER		
1-4-56R	WOOD	WOOD	6'-0"	LEVER		
1-4-56S	WOOD	WOOD	6'-0"	LEVER		
1-4-56T	WOOD	WOOD	6'-0"	LEVER		
1-4-56U	WOOD	WOOD	6'-0"	LEVER		
1-4-56V	WOOD	WOOD	6'-0"	LEVER		
1-4-56W	WOOD	WOOD	6'-0"	LEVER		
1-4-56X	WOOD	WOOD	6'-0"	LEVER		
1-4-56Y	WOOD	WOOD	6'-0"	LEVER		
1-4-56Z	WOOD	WOOD	6'-0"	LEVER		
1-4-57A	WOOD	WOOD	6'-0"	LEVER		
1-4-57B	WOOD	WOOD	6'-0"	LEVER		
1-4-57C	WOOD	WOOD	6'-0"	LEVER		
1-4-57D	WOOD	WOOD	6'-0"	LEVER		
1-4-57E	WOOD	WOOD	6'-0"	LEVER		
1-4-57F	WOOD	WOOD	6'-0"	LEVER		
1-4-57G	WOOD	WOOD	6'-0"	LEVER		
1-4-57H	WOOD	WOOD	6'-0"	LEVER		
1-4-57I	WOOD	WOOD	6'-0"	LEVER		
1-4-57J	WOOD	WOOD	6'-0"	LEVER		
1-4-57K	WOOD	WOOD	6'-0"	LEVER		
1-4-57L	WOOD	WOOD	6'-0"	LEVER		
1-4-57M	WOOD	WOOD	6'-0"	LEVER		
1-4-57N	WOOD	WOOD	6'-0"	LEVER		
1-4-57O	WOOD	WOOD	6'-0"	LEVER		
1-4-57P	WOOD	WOOD	6'-0"	LEVER		
1-4-57Q	WOOD	WOOD	6'-0"	LEVER		
1-4-57R	WOOD	WOOD	6'-0"	LEVER		
1-4-57S	WOOD	WOOD	6'-0"	LEVER		
1-4-57T	WOOD	WOOD	6'-0"	LEVER		
1-4-57U	WOOD	WOOD	6'-0"	LEVER		
1-4-57V	WOOD	WOOD	6'-0"	LEVER		
1-4-57W	WOOD	WOOD	6'-0"	LEVER		
1-4-57X	WOOD	WOOD	6'-0"	LEVER		
1-4-57Y	WOOD	WOOD	6'-0"	LEVER		
1-4-57Z	WOOD	WOOD	6'-0"	LEVER		
1-4-58A	WOOD	WOOD	6'-0"	LEVER		
1-4-58B	WOOD	WOOD	6'-0"	LEVER		
1-4-58C	WOOD	WOOD	6'-0"	LEVER		
1-4-58D	WOOD	WOOD	6'-0"	LEVER		
1-4-58E	WOOD	WOOD	6'-0"	LEVER		
1-4-58F	WOOD	WOOD	6'-0"	LEVER		
1-4-58G	WOOD	WOOD	6'-0"	LEVER		
1-4-58H	WOOD	WOOD	6'-0"	LEVER		
1-4-58I	WOOD	WOOD	6'-0"	LEVER		
1-4-58J	WOOD	WOOD	6'-0"	LEVER		
1-4-58K	WOOD	WOOD	6'-0"	LEVER		
1-4-58L	WOOD	WOOD	6'-0"	LEVER		
1-4-58M	WOOD	WOOD	6'-0"	LEVER		
1-4-58N	WOOD	WOOD	6'-0"	LEVER		
1-4-58O	WOOD	WOOD	6'-0"	LEVER		
1-4-58P	WOOD	WOOD	6'-0"	LEVER		
1-4-58Q	WOOD	WOOD	6'-0"	LEVER		
1-4-58R	WOOD	WOOD	6'-0"	LEVER		
1-4-58S	WOOD	WOOD	6'-0"	LEVER		
1-4-58T	WOOD	WOOD	6'-0"	LEVER		
1-4-58U	WOOD	WOOD	6'-0"	LEVER		
1-4-58V	WOOD	WOOD	6'-0"	LEVER		
1-4-58W	WOOD	WOOD	6'-0"	LEVER		
1-4-58X	WOOD	WOOD	6'-0"	LEVER		
1-4-58Y	WOOD	WOOD	6'-0"	LEVER		
1-4-58Z	WOOD	WOOD	6'-0"	LEVER		
1-4-59A	WOOD	WOOD	6'-0"	LEVER		
1-4-59B	WOOD	WOOD	6'-0"	LEVER		
1-4-59C	WOOD	WOOD	6'-0"	LEVER		
1-4-59D	WOOD	WOOD	6'-0"	LEVER		
1-4-59E	WOOD	WOOD	6'-0"	LEVER		
1-4-59F	WOOD	WOOD	6'-0"	LEVER		
1-4-59G	WOOD	WOOD	6'-0"	LEVER		
1-4-59H	WOOD	WOOD	6'-0"	LEVER		
1-4-59I	WOOD	WOOD	6'-0"	LEVER		
1-4-59J	WOOD	WOOD	6'-0"	LEVER		
1-4-59K	WOOD	WOOD	6'-0"	LEVER		
1-4-59L	WOOD	WOOD	6'-0"	LEVER		
1-4-59M	WOOD	WOOD	6'-0"	LEVER		
1-4-59N	WOOD	WOOD	6'-0"	LEVER		
1-4-59O	WOOD	WOOD	6'-0"	LEVER		
1-4-59P	WOOD	WOOD	6'-0"	LEVER		
1-4-59Q	WOOD	WOOD	6'-0"	LEVER		
1-4-59R	WOOD	WOOD	6'-0"	LEVER		
1-4-59S	WOOD	WOOD	6'-0"	LEVER		
1-4-59T	WOOD	WOOD	6'-0"	LEVER		
1-4-59U	WOOD	WOOD	6'-0"	LEVER		
1-4-59V	WOOD	WOOD	6'-0"	LEVER		
1-4-59W	WOOD	WOOD	6'-0"	LEVER		
1-4-59X	WOOD	WOOD	6'-0"	LEVER		
1-4-59Y	WOOD	WOOD	6'-0"	LEVER		
1-4-59Z	WOOD	WOOD	6'-0"	LEVER		
1-4-60A	WOOD	WOOD	6'-0"	LEVER		
1-4-60B	WOOD	WOOD	6'-0"	LEVER		
1-4-60C	WOOD	WOOD	6'-0"	LEVER		
1-4-60D	WOOD	WOOD	6'-0"	LEVER		
1-4-60E	WOOD	WOOD	6'-0"	LEVER		
1-4-60F	WOOD	WOOD	6'-0"	LEVER		
1-4-60G	WOOD	WOOD	6'-0"	LEVER		
1-4-60H	WOOD	WOOD	6'-0"	LEVER		
1-4-60I	WOOD	WOOD	6'-0"	LEVER		
1-4-60J	WOOD	WOOD	6'-0"	LEVER		
1-4-60K	WOOD	WOOD	6'-0"	LEVER		
1-4-60L	WOOD	WOOD	6'-0"	LEVER		
1-4-60M	WOOD	WOOD	6'-0"	LEVER		
1-4-60N	WOOD	WOOD	6'-0"	LEVER		
1-4-60O	WOOD	WOOD	6'-0"	LEVER		
1-4-60P	WOOD	WOOD	6'-0"	LEVER		
1-4-60Q	WOOD	WOOD	6'-0"	LEVER		
1-4-60R	WOOD	WOOD	6'-0"	LEVER		
1-4-60S	WOOD	WOOD	6'-0"	LEVER		
1-4-60T	WOOD	WOOD	6'-0"	LEVER		
1-4-60U	WOOD	WOOD	6'-0"	LEVER		
1-4-60V	WOOD	WOOD	6'-0"	LEVER		
1-4-60W	WOOD	WOOD	6'-0"	LEVER		
1-4-60X	WOOD	WOOD	6'-0"	LEVER		
1-4-60Y	WOOD	WOOD	6'-0"	LEVER		
1-4-60Z	WOOD	WOOD	6'-0"	LEVER		

GENERAL FINISH NOTES	
1	REFERENCE INTERIOR DESIGN SELECTIONS FOR DEFINITION OF INTERIOR MATERIAL DESIGNATIONS.
2	U.N.O. ALL WALLS TO BE TYPICAL PAINT IPTX1. FLOORING TO BE TERO1. U.N.O.
3	ALL BASE TO MATCH ADJACENT WALL SURFACE. U.N.O.
4	ALL INTERIOR HOLLOW METAL DOOR AND WINDOW FRAMES SHALL BE PAINTED IPTX1 UNLESS NOTED OTHERWISE.
5	ALL OVP BOARD SCOFFS SHALL BE PAINTED IPTX1 UNLESS NOTED OTHERWISE.
6	ALL CASEWORK SHALL HAVE PLOT ON THE CABINETS AND S501 ON THE COUNTERTOPS AND BACKSPLASH UNLESS NOTED OTHERWISE.
7	ALL METAL PORTIONS OF STAIRS SHALL BE PAINTED IPTXX UNLESS NOTED OTHERWISE.
8	REFERENCE AS SERIES DRAWINGS FOR FLOOR PATTERN/FINISH EXTENT PLANS.
9	REFERENCE AS SERIES DRAWINGS FOR MILLWORK INFORMATION.
10	REFERENCE AS SERIES DRAWINGS FOR INTERIOR SPECIALTY ELEVATIONS.
11	REFERENCE AS.00 FOR TYPICAL FLOORING TRANSITION DETAILS.
12	REFERENCE AS SERIES DRAWINGS FOR TYPE AND PLACEMENT OF WALL PROTECTION.
13	REFER TO ELEVATIONS ON A3 SERIES FOR ADDITIONAL FINISH INFORMATION.
14	ALL INTERIOR FINISHES SHALL COMPLY WITH THE FLAME SPREAD AND SMOKE DEVELOPED INDEX REQUIREMENTS PER 2023 IBC AND IFIC. ALL INTERIOR FINISHES SHALL COMPLY WITH THE FLAME SPREAD AND SMOKE DEVELOPED INDEX REQUIREMENTS PER 2023 IBC AND IFIC.
15	PREPARE CONCRETE SLAB PRIOR TO INSTALLATION OF NEW FINISH FLOOR. GRIND, FLOT OR FILL AS REQUIRED TO MEET MFGS' RECOMMENDATIONS FOR EACH SPECIFIC FLOORING TYPE. INSTALLATION DO NOT PROCEED WITH WORK UNTIL ANY DEFECTS HAVE BEEN CORRECTED. THOROUGHLY CLEAN SUBFLOOR PRIOR TO INSTALLATION OF THE FINISH FLOOR.
16	FLOORING CONTRACTOR MUST VERIFY SLAB CONDITIONS PRIOR TO BID AND INSTALLATION. NOTIFY OWNER AND ARCHITECT IF THERE IS ANY MOISTURE CONTENT THAT WILL AFFECT INSTALLATION OF FINISH FLOOR.
17	PROVIDE LEVEL 4 OVP BOARD FINISH ON ALL PARTITIONS U.N.O.
18	ALL PAINT SHALL BE APPLIED IN ACCORDANCE WITH MFGS SPECIFICATION FOR THE PARTICULAR SURFACE. PROVIDE THE FOLLOWING PAINT SHEENS U.N.O.: SEMI-GLOSS, EGGSHELL.
19	TRANSITION OF DIFFERING MATERIALS BETWEEN ROOMS SHALL OCCUR AT THE CENTERLINE OF CLOSED DOOR UNLESS NOTED OTHERWISE.
20	SUBMIT SAMPLES BEFORE PLACING FULL ORDERS WHERE MATERIALS ARE NOT RETURNABLE. NOTIFY ARCHITECT IMMEDIATELY OF ITEMS WITH LONG LEAD TIMES THAT WILL AFFECT THE PROJECT SCHEDULE.
21	MISCELLANEOUS PAINTED ITEMS AND DEVICES NOT OTHERWISE INCLUDED ON THE DRAWINGS ARE TO BE PAINTED TO MATCH THE WALL SURFACE IN WHICH THEY OCCUR. SAMPLES OF SEALANTS ARE TO BE SUBMITTED TO ARCHITECT FOR APPROVAL PRIOR TO INSTALLATION.
22	SEALANTS AND CAULKING ARE TO MATCH THE DOMINANT SURFACE IN WHICH THEY OCCUR. SAMPLES OF SEALANTS ARE TO BE SUBMITTED TO ARCHITECT FOR APPROVAL PRIOR TO INSTALLATION.
23	FINISHES ARE TO EXTEND UNDER ALL MILLWORK AND CASEWORK. TYPICAL MILLWORK SHOWN ON PLANS FOR REFERENCE WITH TRANSPARENCY INCLUDED.

FINISH REMARKS	
1	TYPICAL GLASS STOREFRONT
2	TILE WALL AND/OR BACKSPLASH
3	WOOD WALL PANELS
4	TERRAZZO WALL W/ COVE BASE
5	LARGE FORMAT WALL TILE PANELS
6	GLASS MARKERBOARD WALL PANELS
7	GLASS PANELS
8	SPECIALTY DECORATIVE PANELS
9	SPECIALTY DECORATIVE SCREENS
10	WALL MURALS
11	DIGITAL ART WALL PANELS
12	BRANDING/COLOR WALL INSTALLATION
13	ACOUSTIC WALL PANELS
14	WALL GUARDS AND CORNER GUARDS
15	LEVEL 5 FINISH WALLS WITH BACKING THROUGHOUT

FINISH TAG LEGEND

ROOM FINISH TAG

LINEN STORAGE → ROOM NAME
 0254 → ROOM NUMBER
 FLOOR → VT01
 BASE → RB01
 TYPICAL WALL → IPTX1
 REMARKS → 1

*REMARKS NUMBERS COORDINATE WITH FINISH REMARKS LEGEND LOCATED ON ALL FINISH FLOOR PLAN SHEETS

FINISH EXTENTS AND ANNOTATIONS

WALL FINISHES → IPTXX
 FLOORING MATERIAL TRANSITION → [Symbol]
 MATERIAL GRAN DIRECTION → GRAN [Symbol]

HKS

ARCHITECT
 HKS ARCHITECTS, INC.
 2020 SALZEDO STREET, 4TH FLOOR
 CORAL GABLES, FL 33134

MEP ENGINEER
 SOM ENGINEERING
 5655 BLUE LAGOON DRIVE, STE 205
 MIAMI, FL 33156

STRUCTURAL ENGINEER
 BLES & WYTRM, INC.
 5655 WATERFORD DISTRICT DRIVE, SUITE 400
 MIAMI, FL 33128

CIVIL ENGINEER
 MILLER LEGG & ASSOCIATES, INC.
 13800 NW 5TH STREET
 SUNRISE, FL 33325

LANDSCAPE ARCHITECT
 EDGA, INC.
 1512 E. BROWARD BOULEVARD, SUITE 110
 FT. LAUDERDALE, FL 33301



CASACUBA
BT-925
 PROJECT ADDRESS: Moderna Medicine Campus
 Miami, FL 33199

SEAL & SIGNATURE

INTERIM REVIEW ONLY

These documents are incomplete, and are released for interim review only and are not intended for regulatory approval, permit, or construction purposes.

Architect: NATHAN BUTLER
 Arch. Reg. No.: AR0516491
 Date: 04/19/2024

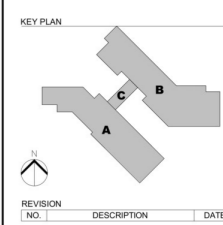

HKS PROJECT NUMBER
25991.000
 DATE
04/19/2024
 ISSUE
ADVANCED SCHEMATIC DESIGN
 SHEET TITLE
FINISH SCHEDULE, NOTES AND DETAILS

SHEET NO.
A9.00

6x8 Door	8.0 EA	
6x10 Door	2.0 EA	
6x8 Door	4.0 EA	
3x8 Door	29.0 EA	
3x8 Door	18.0 EA	
3.5x7 Door	2.0 EA	

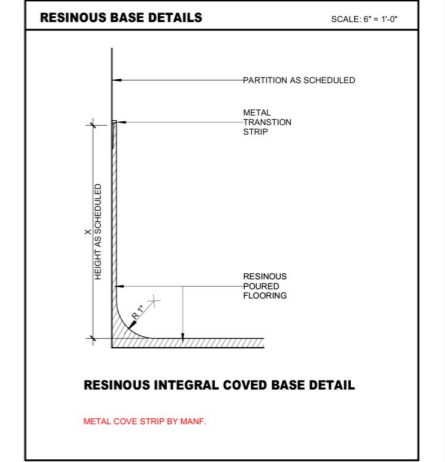

TITLE BLOCK VERSION: 20210303
 MODEL: AutoCAD Doc: 25991.000_Casacuba_202305_P10_Casacuba_2023.rvt
 PRINT DATE: 4/19/2024 10:12:44 AM TEMPLATE VERSION: 2312.4



CASACUBA BT-925

PROJECT ADDRESS: Moderna Medicine Campus
Miami, FL 33199

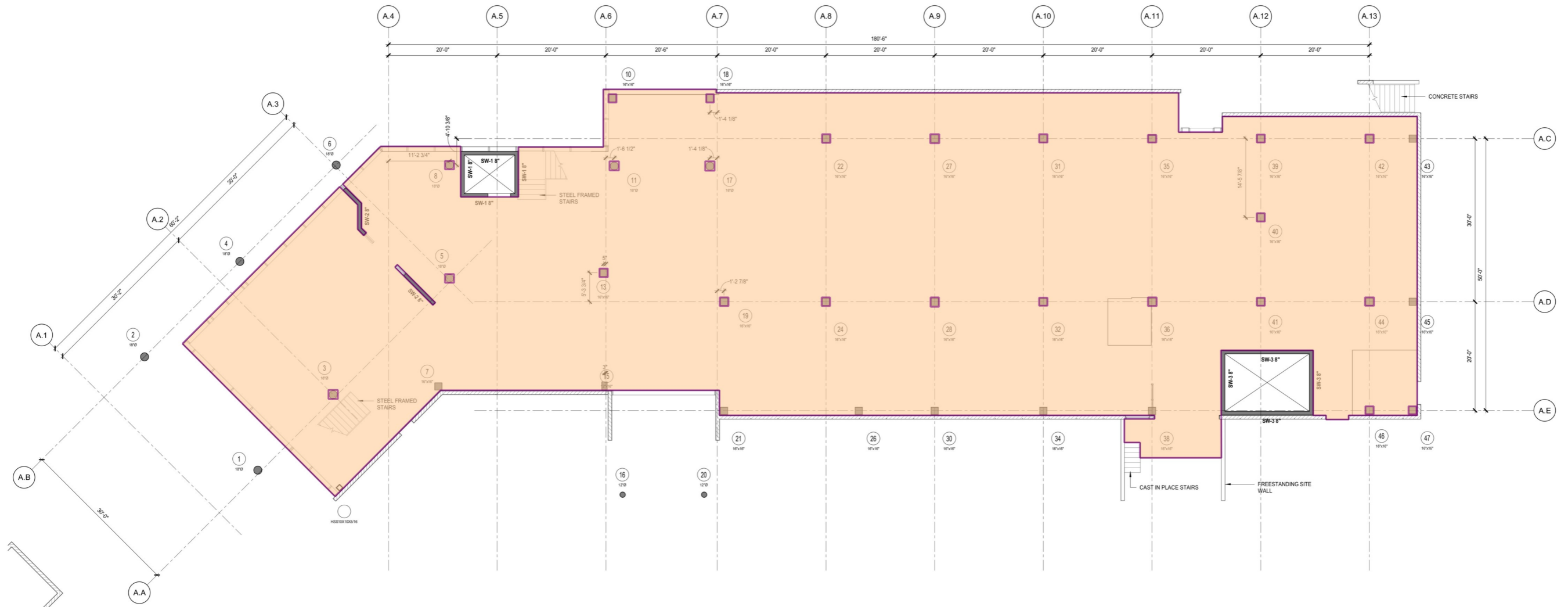

GROUND FLOOR - AREA A
 T.O. SLAB = +100'-0" U.O.N. 1/8" = 1'-0"

PLAN NOTES:
 1. ALL SLABS ON GRADE ARE 4" THICK, U.O.N.

SEAL & SIGNATURE

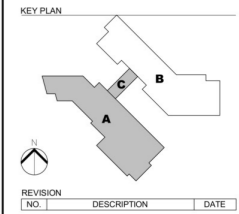

HKS PROJECT NUMBER
25991.000
 DATE
04/19/2024
 ISSUE
**ADVANCED SCHEMATIC
DESIGN**
 SHEET TITLE
**FOUNDATION AND
GROUND FLOOR PLAN -
AREA A**
 SHEET NO.
S2.11

Slab on Grade - Waterproofing

1/2" Isolation Joint

11547.3 SQ FT

833.4 FT

TITLE BLOCK VERSION: 20240320
 MODEL: Archival_Docx\25991.000_Casacuba_25235_PU_Casacuba_2024.rvt
 PRINT DATE: 4/19/2024 10:12:45 AM TEMPLATE VERSION: 23.2.4

HKS
ARCHITECT
 HKS ARCHITECTS, INC.
 2020 SALZEDO STREET, 4TH FLOOR
 CORAL GABLES, FL 33134
MEP ENGINEER
 SCM ENGINEERING
 5855 Blue Lagoon Drive Ste 285
 Miami, Florida 33128
STRUCTURAL ENGINEER
 BLISS & WITTMAN, INC
 580 Village Blvd, Suite 310
 West Palm Beach, FL 33410
CIVIL ENGINEER
 MILLER, EGG & ASSOCIATES, INC
 13680 NW 5th Street
 Sunrise, Florida 33325
LANDSCAPE ARCHITECT
 ED&A, INC.
 Ft. Lauderdale, Florida 33301
 CON4-ADDRESS2



04/22/2024

CASACUBA
BT-925
PROJECT ADDRESS: Moderna Medicine Campus
 Miami, FL 33199

SEAL & SIGNATURE

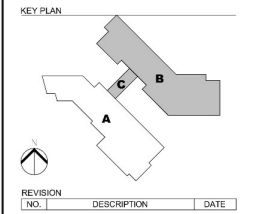

REVISION NO.	DESCRIPTION	DATE

HKS PROJECT NUMBER
25991.000
 DATE
04/19/2024
 ISSUE
ADVANCED SCHEMATIC DESIGN
 SHEET TITLE
FOUNDATION AND GROUND FLOOR PLAN - AREA B
 SHEET NO.
S2.12

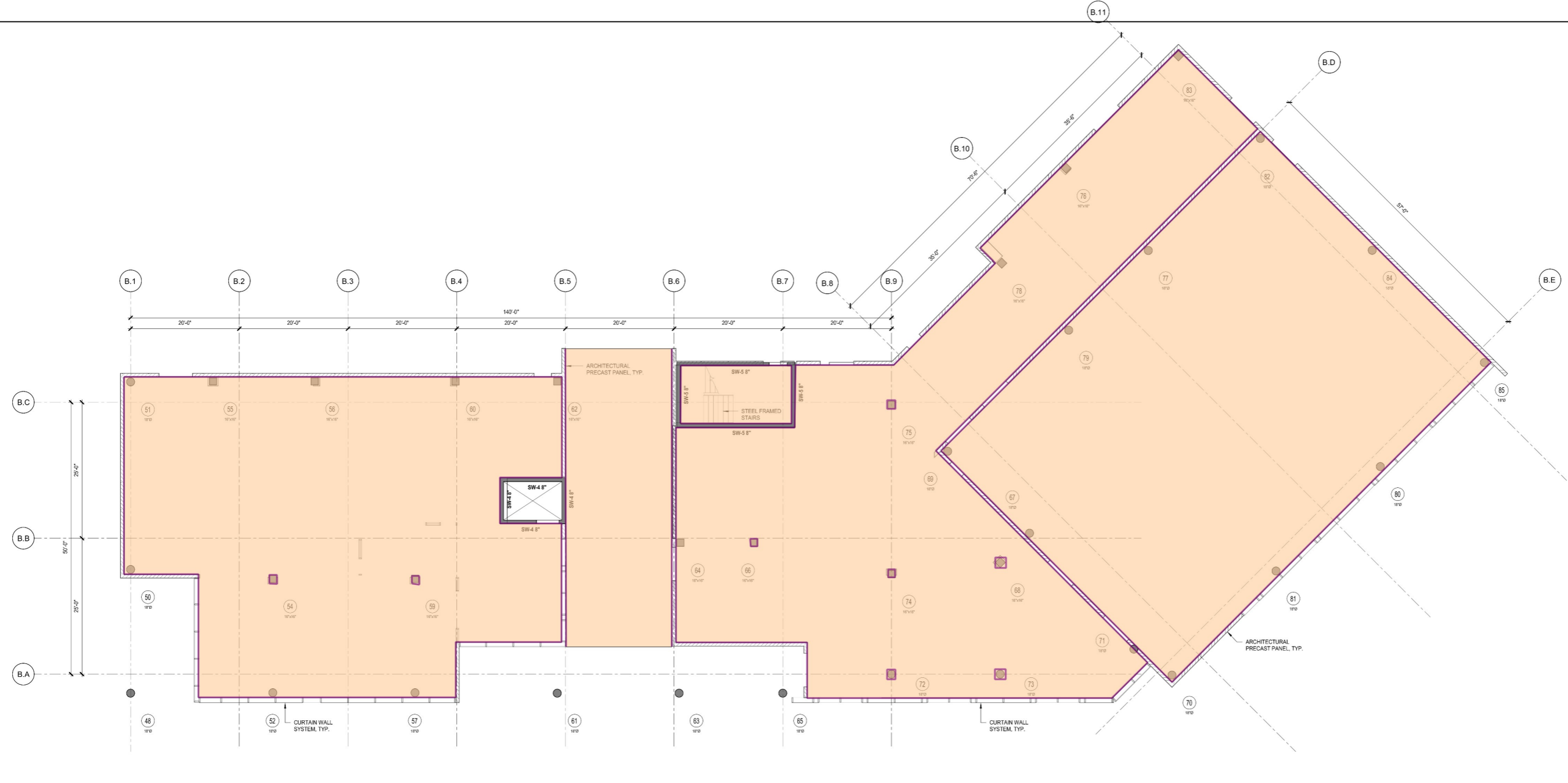

GROUND FLOOR - AREA B
 T.O. SLAB = +100'-0" U.O.N.
 1/8" = 1'-0"
 PLAN NOTES:
 1. ALL SLABS ON GRADE ARE 4" THICK, U.O.N.

Slab on Grade - Waterproofing	15336.3 SQ FT
1/2" Isolation Joint	1243.4 FT

FILE BLOCK VERSION: 20210524
MODEL: AutoCAD 2024
PROJECT: 25991.000 - CASACUBA
DATE: 04/19/2024 10:51 AM
TEMPLATE VERSION: 23.2.4



CASACUBA BT-925

PROJECT ADDRESS: Moderna Medicine Campus
Miami, FL 33199

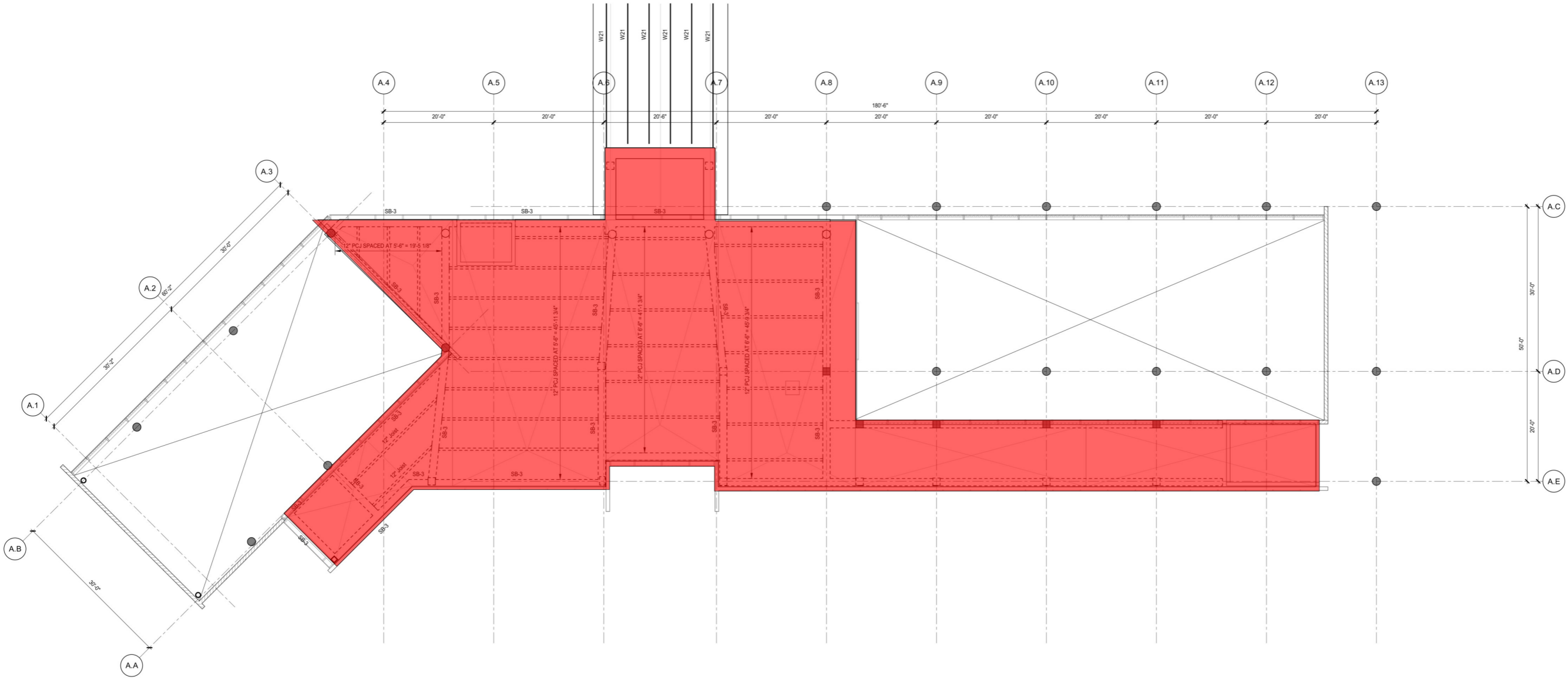

ROOF FRAMING PLAN - AREA A
1/8" = 1'-0"

PLAN NOTES:
1. ALL ELEVATED SLABS ARE 4" THICK, U.O.N.



5715.7 SQ FT

SEAL & SIGNATURE

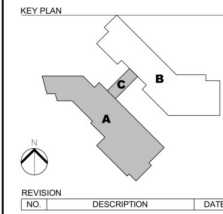

REVISION NO.	DESCRIPTION	DATE
--------------	-------------	------

HKS PROJECT NUMBER
25991.000
DATE
04/19/2024
ISSUE
**ADVANCED SCHEMATIC
DESIGN**
SHEET TITLE
**ROOF FRAMING PLAN -
AREA A**

SHEET NO.
S2.31

TITLE BLOCK VERSION: 20210320
 MODEL: AutoCAD 2024
 PROJECT: 25991.000 - Casacuba 2023-24
 SHEET: 17223.1 - Roof Framing Plan - Area B
 DATE: 04/19/2024 10:15:53 AM
 TEMPLATE VERSION: 2312.4

HKS
 ARCHITECT
 HKS ARCHITECTS, INC.
 2020 SALZEDO STREET, 4TH FLOOR
 CORAL GABLES, FL 33134
 MEP ENGINEER
 SGM ENGINEERING
 5855 Blue Lagoon Drive Ste 285
 Miami, Florida 33128
 STRUCTURAL ENGINEER
 BLISS & WITTRAY, INC
 580 Village Blvd, Suite 310
 West Palm Beach, FL 33410
 CIVIL ENGINEER
 MILLER, EGG & ASSOCIATES, INC
 13680 NW 5th Street
 Sunrise, Florida 33325
 LANDSCAPE ARCHITECT
 EDSA, INC.
 Ft. Lauderdale, Florida 33301
 CON-4 ADDRESS2



CASACUBA
BT-925
 PROJECT ADDRESS: Moderna Medicine Campus
 Miami, FL 33199

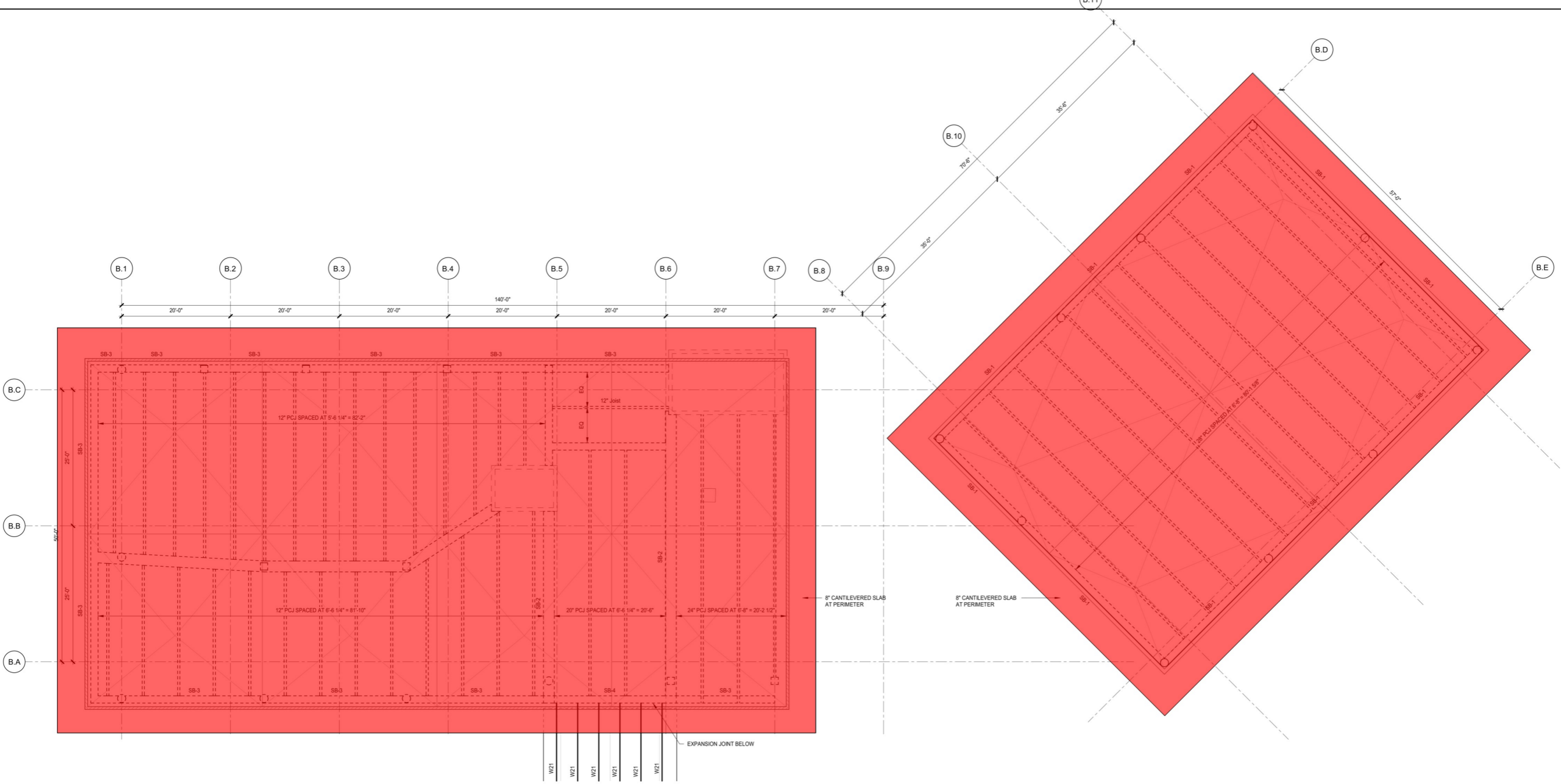

ROOF FRAMING PLAN - AREA B 1/8" = 1'-0"

- PLAN NOTES:
1. ALL ELEVATED SLABS ARE 4" THICK, U.O.N.

17223.1 SQ FT

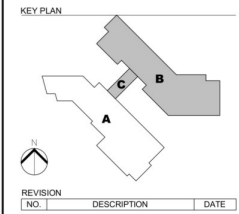

REVISION NO.	DESCRIPTION	DATE

HKS PROJECT NUMBER
25991.000
 DATE
04/19/2024
 ISSUE
ADVANCED SCHEMATIC DESIGN
 SHEET TITLE
ROOF FRAMING PLAN - AREA B
 SHEET NO.
S2.32

